

Legals

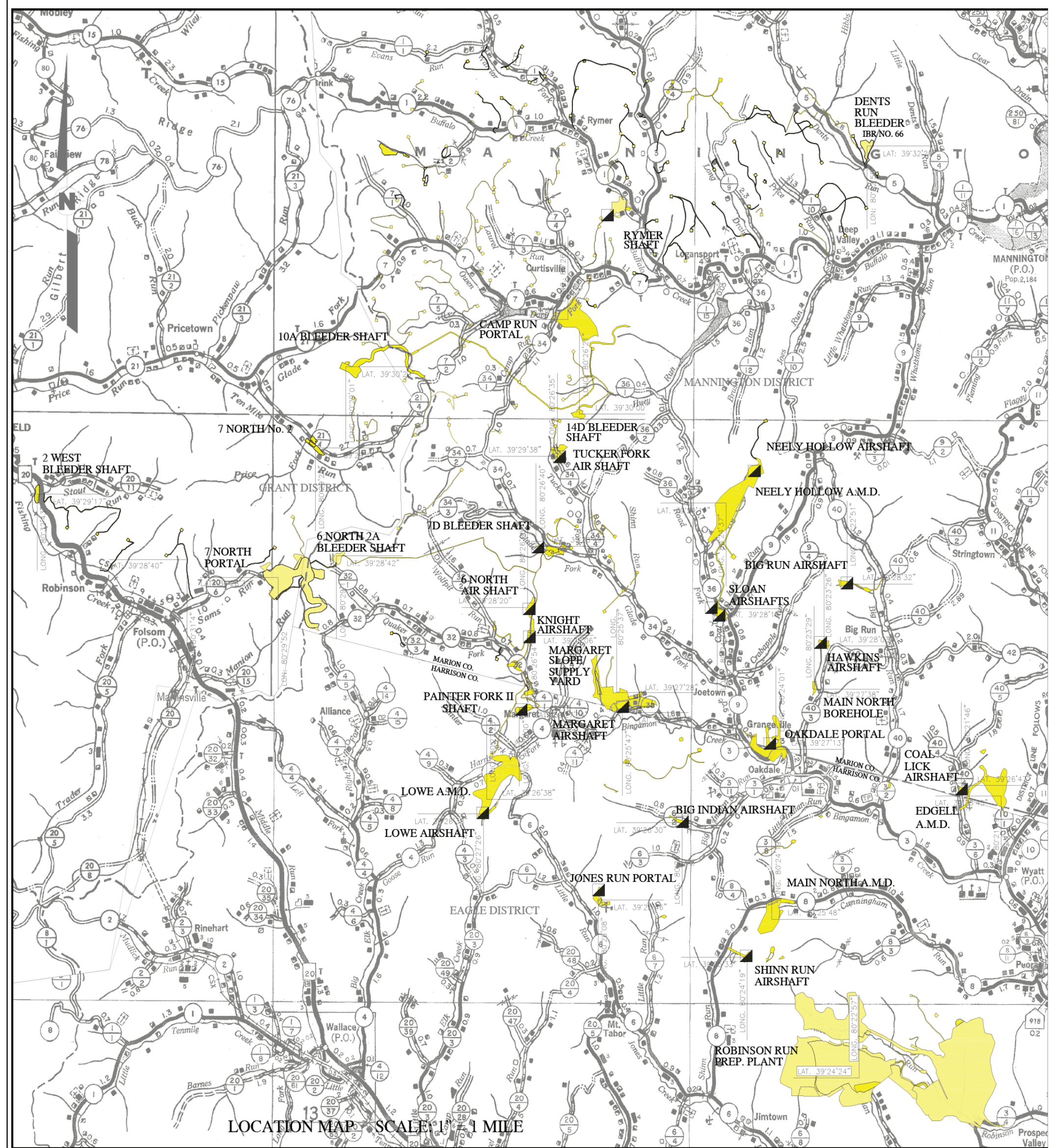

LOCATION MAP SCALE 1" = 1 MILE

GENERAL LOCATION MAP

Harrison County Coal Resources, Inc.
 U010483 - Permit Transfer
 Mannington District of Marion County
 Eagle & Sardis Districts of Harrison County
 Grant District of Wetzel County
 Nearest P.O. - 2.9 Miles Northwest of Lumberport
 Shinnston, Wallace, Glover Gap, and Folsom USGS Quadrangles
 Scale 1" = 1 Mile

Advertisement

Notice is hereby given that Harrison County Coal Resources, Inc., 46226 National Road, St. Clairsville, OH 43950 has submitted an application to the Department of Environmental Protection (DEP) 47 School Street, Suite 301, Philippi, WV 26416-1600.

This application has been submitted for Transfer, assignment or sale on Permit No(s). U010483, U102592 from The Harrison County Coal Company, 46226 National Road, St. Clairsville, OH 43950.

Comments on the application shall be in writing and shall identify the applicant and application number and be sent to the Department of Environmental Protection (DEP) at the address above. Comments received by 10/30/20, or thirty (30) days from date of publication, will be considered.

A copy of the application will be available until 10/30/20, or thirty (30) days from the date of publication in the DEP Regional Office located at the address above and is available at:

https://apps.dep.wv.gov/WebApp/_dep/Search/ePermitting/ePermittingApplicationSearchPage.cfm

The above link can be accessed from a computer at all West Virginia public libraries. DEP Telephone No. 304-457-3219

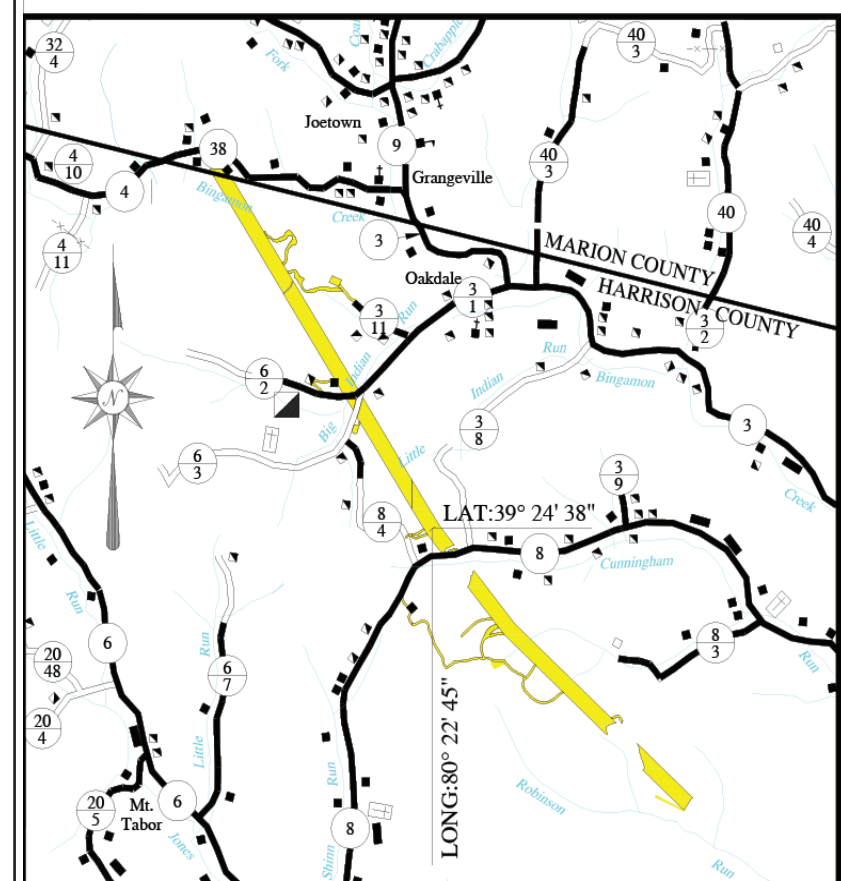

LOCATION MAP

HARRISON COUNTY COAL RESOURCES, INC.
 PERMIT NO. U-1025-92
 MANNINGTON DISTRICT OF MARION COUNTY
 EAGLE DISTRICT OF HARRISON COUNTY
 NEAREST P.O. - 4 MILES EAST TO WYATT
 SHINNSTON AND WALLACE QUADRANGLES
 SCALE 1" = 1 MILE